

METAL SAFETY QUICK COUPLINGS - CSM 11

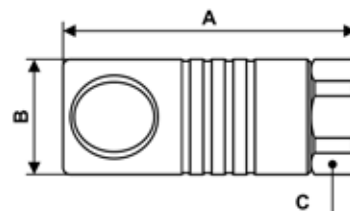

Parallel female thread coupler

Profile : ISO 6150C



Min / Max operating pressure	Flow rate at 6 bar	ID passage	Min. / Max temperature
2 / 16 bar	4120 l/min	11 mm	-15 / 70 °C

Part number	Female thread	Dim. A (mm)	Dim. B (mm)	Dim. C (mm)
CSM 111102	G3/8	84	33	30
CSM 111103	G1/2	87	33	30
CSM 111104	G3/4	92	33	30